

# SERVITUDE DIAGRAM

SIDES Metres		ANGLES OF DIRECTION	CO-ORDINATES Y System: WG 27° X			S.G. No.
		Constants:		± 0,00	± 0,00	Approved  for SURVEYOR- GENERAL
AB	67,75	234 10 35	A	-82 673,08	+2 835 824,21	
BC	100,57	4 02 50	B	-82 728,01	+2 835 784,56	
CD	52,00	94 02 00	C	-82 720,91	+2 835 884,88	
DA	57,15	184 02 50	D	-82 669,04	+2 835 881,22	
CONNECTING		DATA				
DE	61,62	94 02 00	E	-82 607,58	+2 835 876,88	
CF	107,38	274 02 00	F	-82 828,03	+2 835 892,43	
	Brit 90	157	△	-88 368,60	+2 835 885,88	
	Alpha	410	△	-80 882,62	+2 836 380,29	

Description of Beacons

A,B,C,D,E,F : Iron Standard

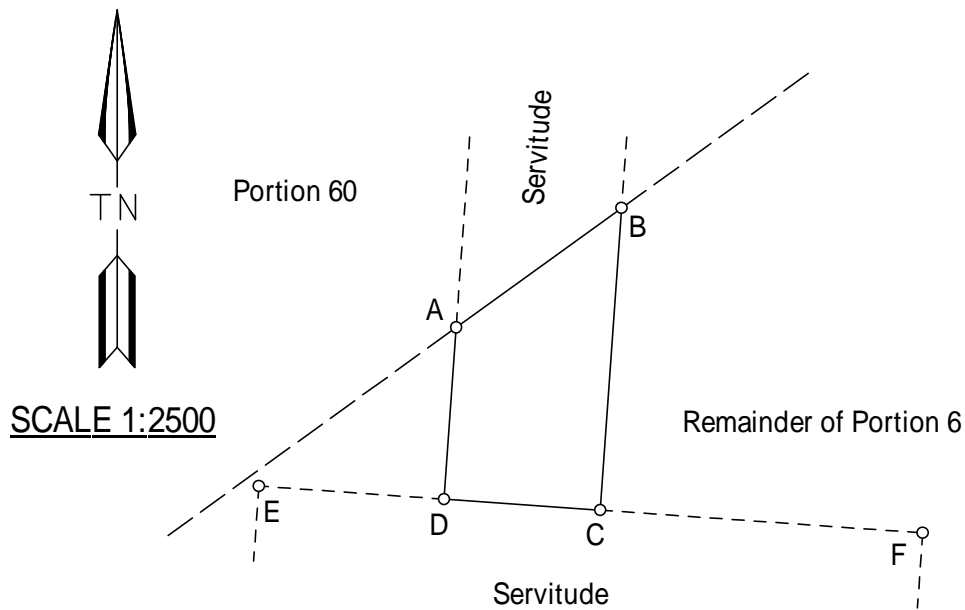

The figure A B C D A represents  
 4100 Square metres of land being an  
**ELECTRIC POWERLINE SERVITUDE**  
 over the Remainder of Portion 6  
 of the farm  
**ELANDSFONTEIN No. 440 - JQ**

**North-West Province**

Surveyed in February and March 2013 by me

  
 M.P.A. COETSEE PLS 0105  
 Professional Land Surveyor

COETSEE NEL INC. 013 262 4136

This diagram is annexed to	The original diagram is	File :
No.	S.G. No. : A 585/1914	S.R. :
	Transfer T 1821/1915	Comp. : JQSK 13
Registrar of Deeds PRETORIA		